

LEGEND

- IRF=IRON ROD FOUND
- IRS=IRON ROD SET WITH CAP
- L=LIBER-FOLIO
- PB, P.=PLATBOOK-PAGE
- R/W=RIGHT-OF-WAY
- WM=WATER METER
- SCO=SEWER CLEAN OUT
- WV=WATER VALVE
- CLF=CHAIN LINK FENCE
- RCP=REINFORCED CONCRETE PIPE
- CHDPE=CORRUGATED HDPE PIPE
- ☐=PHONE BOX
- ☼=LIGHT POLE
- ⊕=HANDICAP PARKING
- ⊕=UTILITY POLE
- ⊕=FIRE HYDRANT
- ⊕=TREE
- ⊕=BUSH
- ⊕=CREPE MYRTLE
- E---=OVERHEAD UTILITY LINES
- S---=SANITARY SEWER LINES
- EPM---=ELECTRIC LINE PAINT MARKING
- CPM---=COMMUNICATION LINE PAINT MARKING
- W---=WATER LINE PAINT MARKING
- B---=BUILDING RESTRICTION LINE
- 23---=CONTOUR LINE
- C---=CONCRETE
- ASPH---=ASPHALT

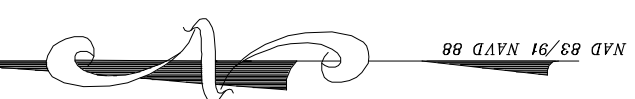
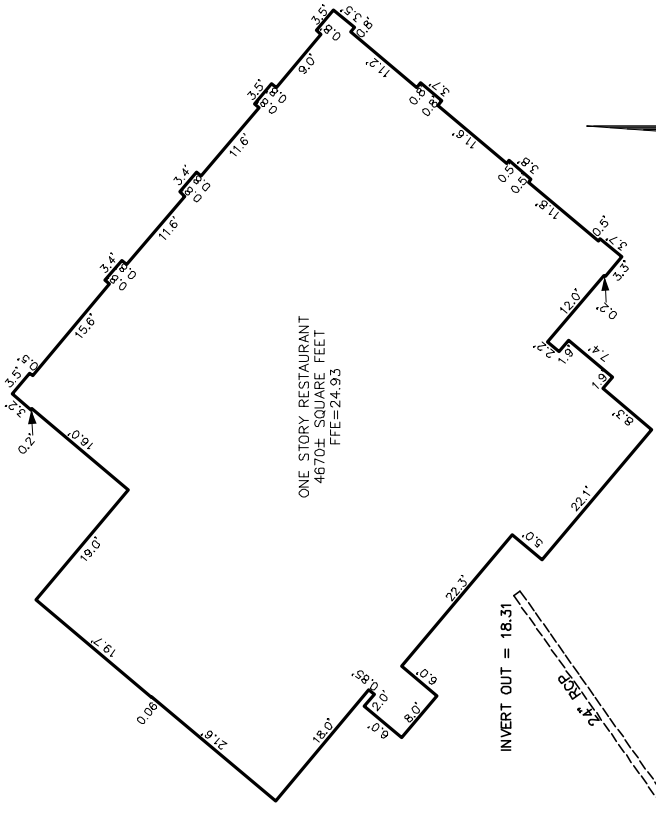
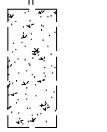

POINT LOOKOUT ROAD
 MARYLAND STATE ROUTE 5
 (S.R.C. PLATS NO. 34027 AND 34028)
 R/W VARIES

LOT 2
 65,340 SQ. FT.
 OR
 1.50000 ACRES

ALTA/NSPS LAND TITLE SURVEY
LOT 2
GORDON H. RAGAN SUBDIVISION
PLAT BOOK 39 PLAT 78

TAX MAP 120 PARCEL 394
 40874 MERCHANTS LANE
 TOWN OF LEONARDTOWN
 3RD. ELECTION DISTRICT
 ST. MARYS COUNTY, MARYLAND

REVISED JULY 10, 2023

DH Steffens Co.
 ESTABLISHED 1923
ENGINEERS - SURVEYORS - PLANNERS
 Copyright ©
 Internet: www.dhsteffens.com Email: dhsteffensco@dhsteffens.com

PREPARED FOR

THE WILLS GROUP
 ATTN: MR. BRIAN FENWICK
 102 CENTENNIAL STREET
 LA PLATA, MD 20646
 Telephone: (301) 970-3251
 (Mer) Fax: (301) 884-3295

SHEET 2 OF 2 DATE 06/2023
 DRAWN BY PAW FILE # S12018
 SCALE 1" = 30'



N/F
 VISHVA ENTERPRISES LLC
 LOT 5
 PB.51 P.25
 L.2060 F.544

Photo A. Williams Prof. L.S.